

**tyco**

Electronics

RoHS  
Ready 

# AMP SUPERSEAL 1.5 Series Connectors

GLOBAL AUTOMOTIVE DIVISION



# TYCO ELECTRONICS GLOBAL AUTOMOTIVE DIVISION

▶ Driver Information

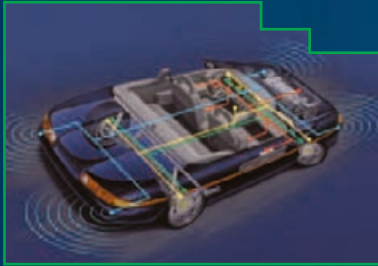

▶ Safety Systems

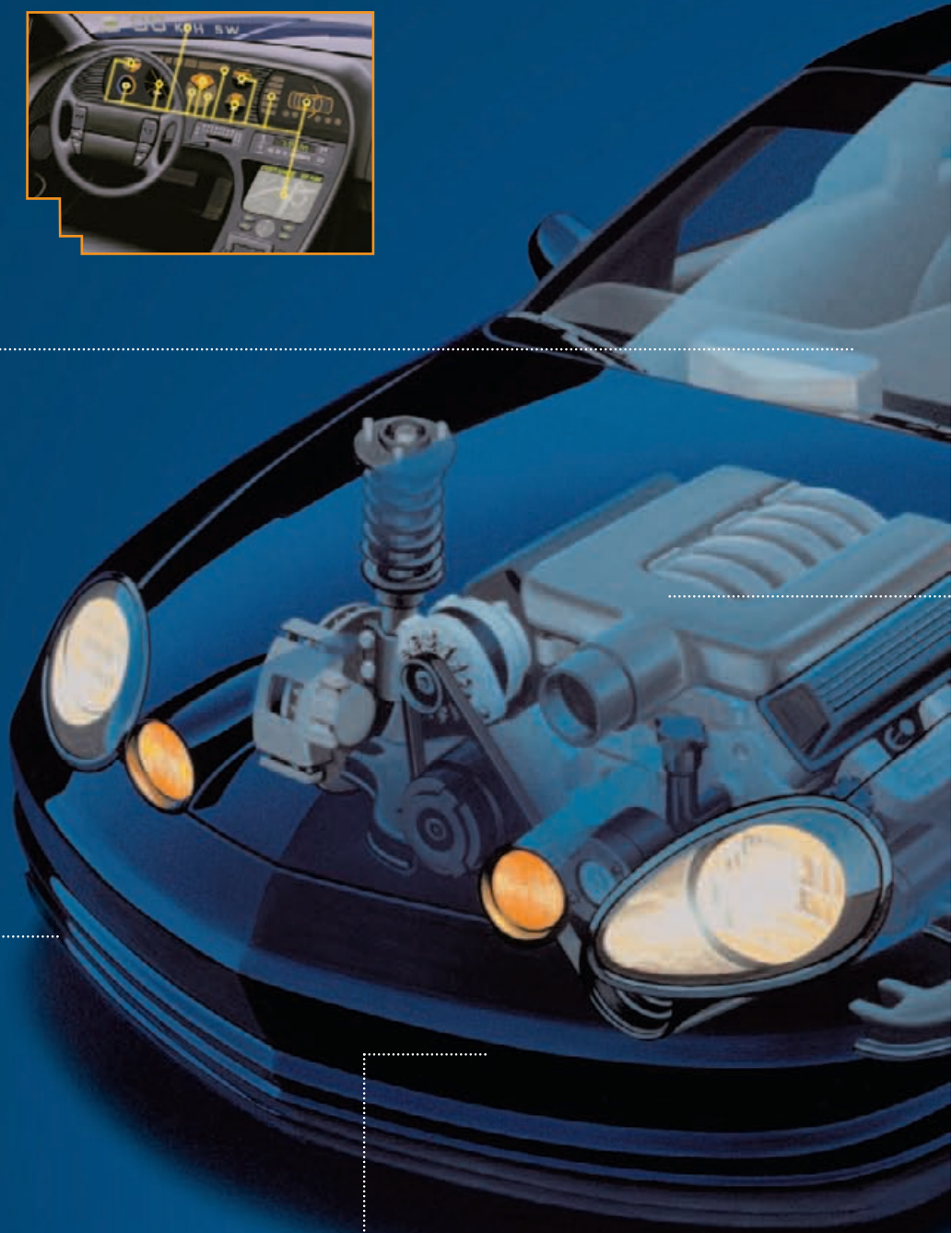

▶ Body

# THE 7 APPLICATION AREAS



▶ Convenience

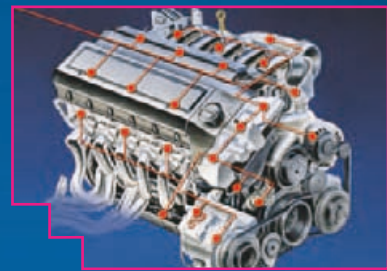

▶ Powertrain Systems

▶ Security



▶ Chassis Systems

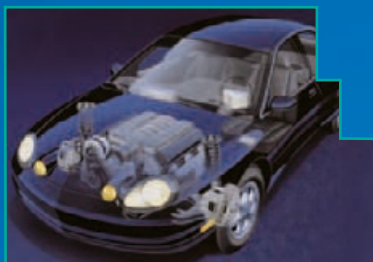

## INNOVATIVE TECHNOLOGIES

***Tyco Electronics is one of the major business units of Tyco International Ltd. Headquartered in Harrisburg, Pennsylvania, USA. Tyco Electronics is the world's largest passive electronic components manufacturer and a world leader in cutting-edge wireless technologies. The company has facilities located in over 50 countries, serving customers in the aerospace, automotive, computer, communications, consumer electronics, industrial and power industries. The global automotive division follows the globalization goals of our customers, speeds up the integration of new technologies and enables our customers access to our vast product portfolio and services.***

---

## TERMINALS & CONNECTORS



Tyco Electronics offers a broad range of high quality terminals and connectors. Our electrical and electronic interconnection products and solutions are used to electrically and mechanically join wires and cables, printed circuit boards, integrated circuit packages and batteries. Our growing capabilities include new copper and fiber-optic connectors, wires, cables and cable management systems that are designed to meet automotive industry demands. The AMP brand encompasses the broadest range of connectors in the world, including high-density, high-speed designs for leading-edge communications equipment.

LITERATURE NO. 1308092-1

---

## MECHATRONICS



A variety of technical products is designed today by integrating mechanical components and electronic hardware into one packaging unit thus creating true mechatronic solutions. Mechatronic applications offer amazing and versatile potentials related to functionality, cost, space requirements and quality. Tyco Electronics contributes to those applications with its wide range of innovative and cost-effective product and process technologies.

Advanced stamping, injection molding and assembly techniques are applied along with highly selective surface plating methods.

LITERATURE NO. 1308091-1

---

## CLOCKSPRING SYSTEMS

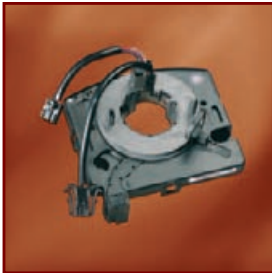

Automotive technology and integrated systems continue to develop at a rapid pace with electric and electronic systems playing an important role in traffic safety and travel comfort.

The Safety Systems (SAS) subdivision of Tyco Electronics' Global Automotive Division offers a wide range of engineering "know-how" and production facilities concerning electrical transfer units ("clocksprings") for steering wheel airbag devices. Tyco Electronics has a remarkable combination of

competencies in development, production, application support and related technologies to ensure a competitive edge for business growth worldwide.

LITERATURE NO. 1308088-1

## SENSOR TECHNOLOGY



Tyco Electronics offers non-contact sensors for a variety of applications. As sensor manufacturer and processing partner, we also provide project planning support for new sensor applications, assistance in the selection of the appropriate sensor technology for the respective application, and assistance with defining the corresponding mechanical, electrical and magnetic interface. Tyco Electronics has a broad electromechanical portfolio that includes robust housing technologies, connector systems, and

temperature stable designs based on foil and cable networks. This combination of technologies and experience ensures that reliable and cost effective sensor solutions are available for all application types.

LITERATURE NO. 1308086-1

## RELAYS AND SWITCHING MODULES



Automotive technology and integrated systems continue to develop at a rapid pace with electric and electronic systems playing an important role in traffic safety and travel comfort. Tyco Electronics is the world's number one supplier for automotive relays and switching modules (AR & SM), offering a wide range of vital components for safety systems.

Tyco Electronics has a remarkable combination of competencies in development, production, application support and related technologies to

ensure a competitive edge for business growth worldwide.

LITERATURE NO. 1308085-1

## POWER DISTRIBUTION SYSTEMS



The extensive net of electrical and electronic loads in vehicle environments requires the next evolution of complex powernet structures such as intelligent control and distribution systems. Tyco Electronics offers modules with intelligent technology for power distribution units with integrated switching and protection functions. Our power distribution systems offer maximum flexibility and modularity at the highest package density that can be customized based on customer requirements.



LITERATURE NO. 1308087-1

## INDUCTIVE SYSTEMS



Tyco Electronics, Global Automotive Division, is your source for interconnection and wireless technologies for automotive, truck and off-highway OEMs and Tier 1 suppliers

Tyco Electronics has inductive system components that are suitable for any LF-application in the vehicle environment. Tyco Electronics offers a vast Inductive Systems product portfolio which includes antennas, actuators and integrated modules. Applications are developed using cost-effective engineering and are focused on customized designs based on customer requirements.



LITERATURE NO. 1308089-1

## HYBRID SYSTEMS



Tyco Electronics is a leader in next-generation transportation technologies and products for hybrid and electric vehicles. The Global Automotive Division is your source for high voltage power distribution, high current contacts, high voltage connectors and cables, high voltage relays, sensors and temperature protection devices for hybrid and other alternative powered vehicles.



LITERATURE NO. 1308093-1

## HIGH SPEED COMMUNICATION



With the introduction of the D2B Optical Networking System in 1997, the way was set for the automotive world to start reaping the benefits for optical data transmission.

The advantages of Optical Networking were attracting the attention of many other car OEM's and in 1998 with the foundation of the MOST® Cooperation the first steps were taken to build on the work of the D2B technology and spread the benefits of the Optical Networking technology throughout the automotive world. The MOST Cooperation focused on developing an optical network specification defining all key interface points which would enable the automotive supplier market to develop components when based on the MOST Specification to be compatible and interoperable.

**MOST® IS A REGISTERED TRADEMARK OF OASIS**

LITERATURE NO. 1308084-1

## WIRELESS TECHNOLOGIES RADAR SENSORS & ANTENNAS FOR TELEMATICS



Tyco Electronics offers wireless sensors for automotive and off-highway applications for just about any location in the vehicle. We are first to market in-radar based sensors for truck collision warning systems, autonomous cruise control systems and short-range sensor systems.

Tyco Electronics also offers quad band antennas which use Satellite Radio (SDARS), GPS and two cellular bands that comply with current vehicle navigation and safety system antenna requirements.

LITERATURE NO. 1308090-1

## A VITAL PART OF YOUR WORLD

Tyco businesses operate in thousands of different areas of industry. The products and services we deliver all have one thing in common: *They are vital to everyday living.* Individuals and companies worldwide have critical needs, and every minute of every day, Tyco is satisfying those needs.

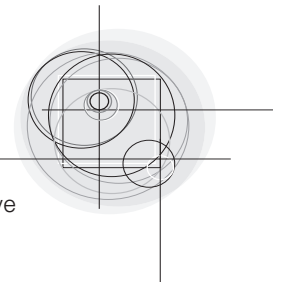

# TYCO ELECTRONICS "TECHNOLOGY PORTFOLIO"

---



---

■ Connector Systems /  
Electromechanical  
Components

---

■ Relays

---

■ Wireless

---

■ Antennas, GPS Antennas

---

■ Sensors

---

■ Fiber Optic (Passive)

---

■ Heat Shrink Tubing

---

■ Wire & Cable

---

---

■ Printed Circuit Board  
Technologies

---

■ Circuit Protection Devices

---

■ Touchscreens /  
Interactive Displays

---

■ Application Tooling

---

■ Battery Assemblies

---

■ Power Systems /  
Electronic Modules

---

■ Magnetics

---

■ Resistors and Inductors

---

---

■ Heat Sinks /  
Thermal Management

---

■ Switches

---

■ Identification &  
Labeling Products

---

■ Racks and Panels

---

■ Smart Cards /  
Leadframes

---

■ Clock Springs

---

■ Small Motors (20–1,500 W)

---

# TYCO ELECTRONICS "AT YOUR SERVICE"



## Tyco Electronics Online

The Tyco Electronics website is an innovative and interactive source for application information, product updates and technical solutions.

Our step-by-step software makes our website intuitive and user-friendly to better serve you!

Please contact us at:

[www.tycoelectronics.com/automotive](http://www.tycoelectronics.com/automotive)

## Internet Homepage

[www.tycoelectronics.com](http://www.tycoelectronics.com)

[www.tycoelectronics.com/automotive](http://www.tycoelectronics.com/automotive)

## Electronic Internet Catalog

[www.catalog.tycoelectronics.com](http://www.catalog.tycoelectronics.com)

## Product Information Center (PIC)

You can rely on Tyco Electronics PIC Team to provide you support for answers to your general information or technical questions in an efficient and effective manner. To reach our PIC staff, please contact your local Tyco Electronics organization.



## Product and Machine Literature

Tyco Electronics offers a variety of product specific catalogs, brochures and high impact flyers to help better serve you!

For more information on literature for Tyco Electronics' Global Automotive Division, please contact your local Tyco Electronics Organization or go to

[www.tycoelectronics.com/automotive](http://www.tycoelectronics.com/automotive)





~~Powertrain  
Systems~~



~~Chassis  
Systems~~



~~Safety  
Systems~~



~~Security~~

Page

## AMP SUPERSEAL 1.5 Series Connectors

Introduction	11	●	●	●	●
<b>Contact System</b>					
Receptacle Contacts	12	●	●	●	●
Tab Contacts	13	●	●	●	●
Wire Seals and Cavity Plugs	14	●	●	●	●
<b>Housings and Connectors</b>					
Plug Housings	15	●	●	●	●
Cap Housings	16	●	●	●	●
Rubber Boots	17	●	●	●	●
<b>Application Tooling</b>					
Introduction	19	●	●	●	●
Stripper-Sealer-Crimper bt 752	21	●	●	●	●
Seals Module mci 761	22	●	●	●	●
Seals Module mci 762	23	●	●	●	●

# THE PRODUCTS



Body



Driver Information



Convenience



Car Industry



Truck Industry



Other Industry

●	●	●		●	●
●	●	●		●	●
●	●	●		●	●
●	●	●		●	●
●	●	●		●	●
●	●	●		●	●
●	●	●		●	●
●	●	●		●	●

Engineering Notes



Introduction



~~Powertrain  
Systems~~



~~Chassis  
Systems~~

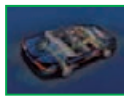

~~Safety  
Systems~~



~~Security~~



~~Body~~



~~Driver  
Information~~



~~Convenience~~

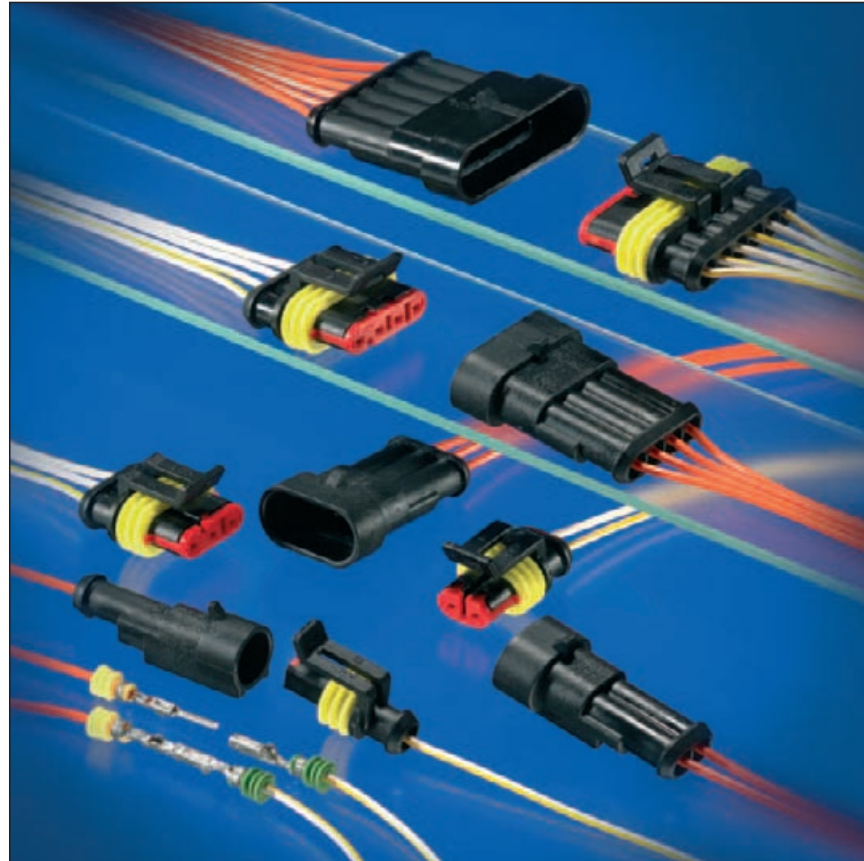

~~Car  
Industry~~



~~Truck  
Industry~~



~~Other  
Industry~~

Tyco Electronics has developed the AMP SUPERSEAL 1.5 Series Connector family to meet the increasing requirements for reliability and water proofness.

AMP SUPERSEAL 1.5 Series Connector exceed the requirements prescribed by IP 67 according IEC 60529 and DIN 40050-9 standards and has its application in the automotive, agriculture and industrial machinery.

For sensor application the AMP SUPERSEAL 1.5 Series Connector system is qualified as well.

**Advantages**

- Compact system minimizes packaging requirements
- Sealing reliability proven under harsh conditions
- Designed for ease of manual harness assembly, engine mounting and under hood environments

**Applications**

- Wire-to-Wire (1.5 mm) and ECU applications, under hood or any location where sealing is required
- Suitable for automotive, truck, bus, or off-road vehicles

Receptacle Contacts

**Technical Features**

**Contact Material:**  
CuZn (Tab)  
CuSn (Receptacle)

**Contact Finish:**  
tin plated

**Current Carrying Capacity:**  
14 A max.

**Wire Size Range:**  
0.35–2.5 mm<sup>2</sup>

**Insulation Diameter:**  
1.2–3.3 mm FLR

**Extraction Tool:**  
Part No. **9-1579007-1**

**Product Specification:**  
108-20090

**Application Specification:**  
114-20045

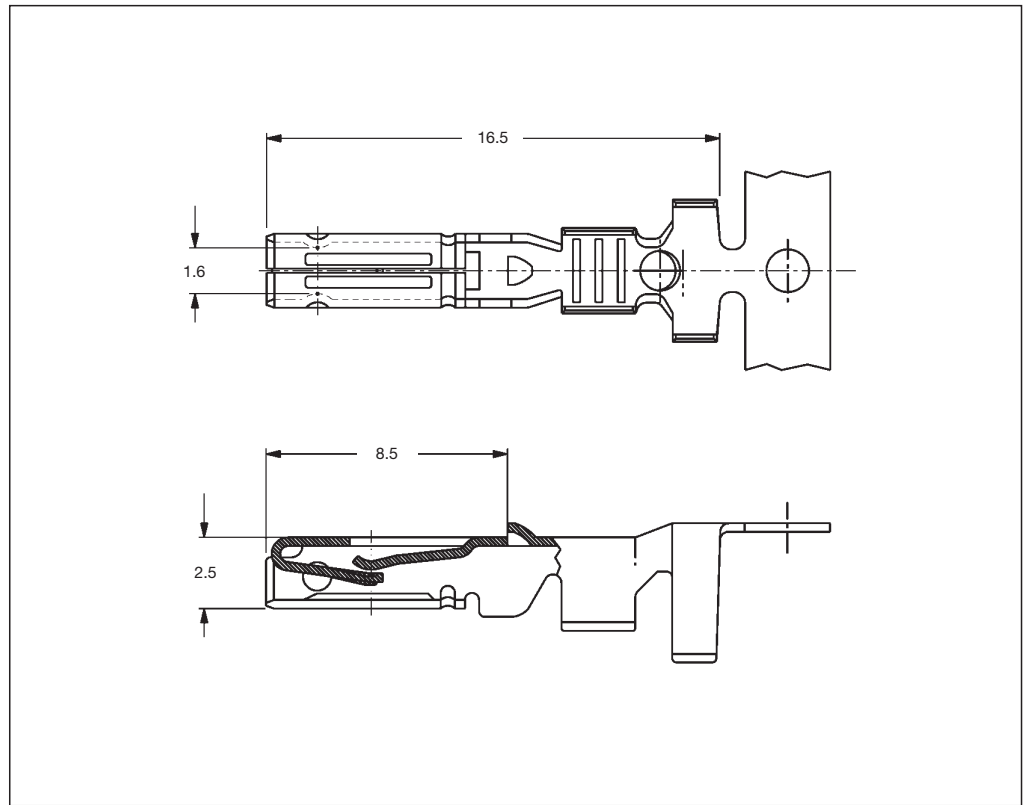

**1.5 mm Receptacle Contacts**

Wire Size Range (mm <sup>2</sup> )	Insulation Diameter (mm)		Material and Finish	Part Numbers				Applicator	Hand Tool
	FLK	FLR		Strip Form	Package Quantity	Loose-Piece	Package Quantity		
0.35–0.50	1.45–2.20	1.2–1.6	CuSn, tin plated	282403-1	14,000	183035-1	5,000	1528347-1	58583-1
0.75–1.50	2.40–3.35	1.7–2.4	CuSn, tin plated	282110-1	14,000	183025-1	5,000	1528018-1	58583-1
1.5–2.5	3.15–3.80	2.2–3.3	CuSn, tin plated	282466-1	14,000	–	–	1426361-1	–

**Note:** All part numbers are RoHS and ELV compliant.

Tab Contacts

**Technical Features**

**Contact Material:**

CuZn (Tab)  
CuSn (Receptacle)

**Contact Finish:**

tin plated, gold plated

**Current Carrying Capacity:**

14 A max.

**Wire Size Range:**

0.35–2.5 mm<sup>2</sup>

**Insulation Diameter:**

1.2–3.3 mm FLR

**Extraction Tool:**

Part No. **9-1579007-1**

**Product Specification:**

108-20090

**Application Specification:**

114-20045

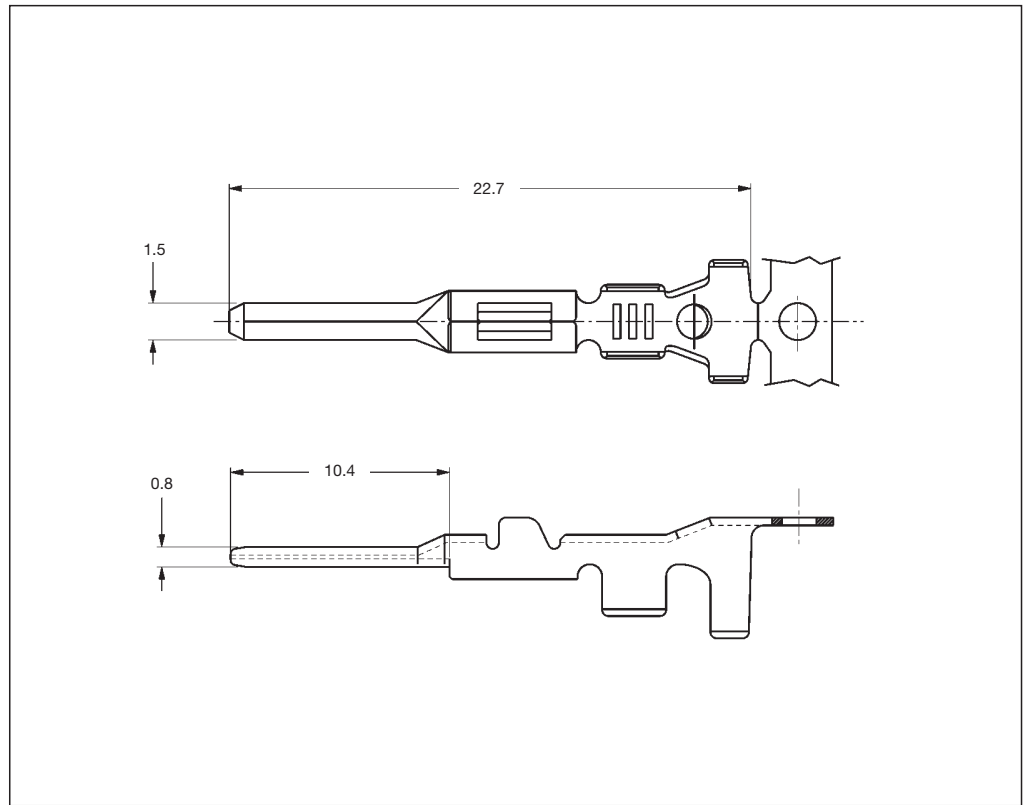

**1.5 mm Tab Contacts**

Wire Size Range (mm <sup>2</sup> )	Insulation Diameter (mm)		Material and Finish	Part Numbers				Applicator	Hand Tool
	FLK	FLR		Strip Form	Package Quantity	Loose-Piece	Package Quantity		
0.35–0.50	1.45–2.20	1.2–1.6	CuZn, tin plated	282404-1	16,000	183036-1	5,000	1528199-1	58583-1
			CuZn, gold plated	282404-3	16,000	–	–		
0.75–1.50	2.40–3.35	1.7–2.4	CuZn, tin plated	282109-1	16,000	183024-1	5,000	1528463-1	58583-1
			CuZn, gold plated	282109-3	16,000	–	–		
1.5–2.5	3.15–3.80	2.2–3.3	CuZn, tin plated	282465-1	16,000	–	–	1528200-1	–

**Note:** All part numbers are RoHS and ELV compliant.

Single Wire Seals and Cavity Plugs

**Technical Features**

- Made from silicon rubber material
- For insulation diameters of 1.2–3.3 mm
- Loose-piece wire seals are crimped simultaneously with the contacts

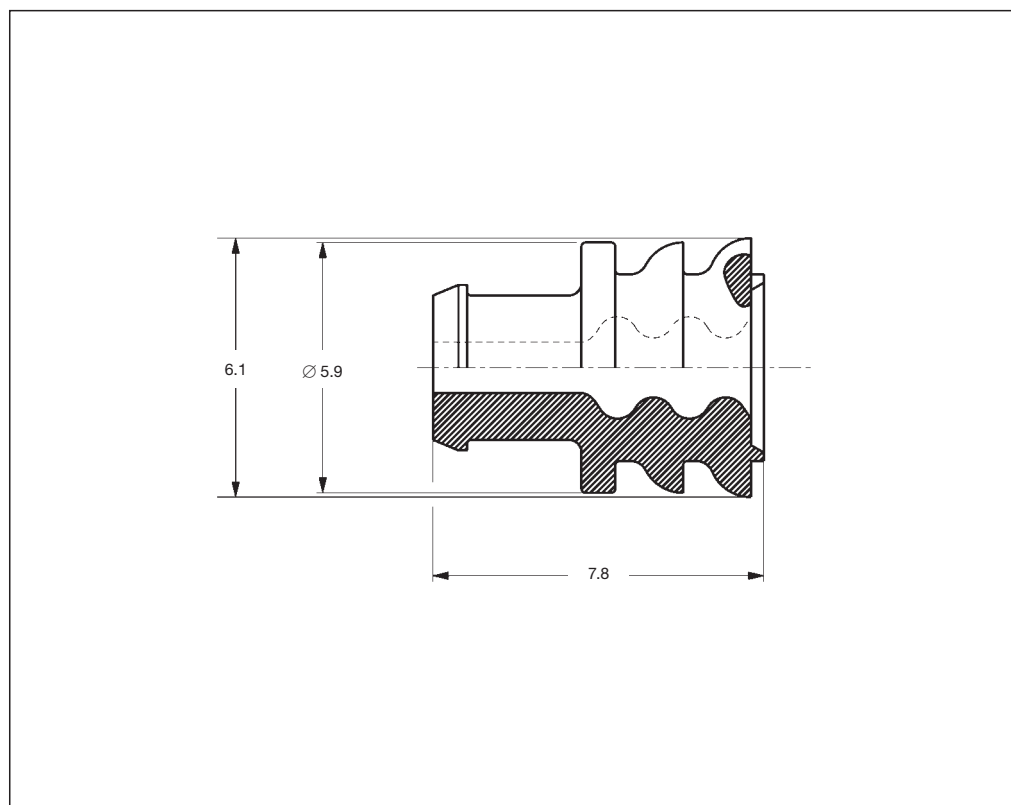

**Single Wire Seals and Cavity Plug**

Insulation Diameter (mm)		Color	Part Number	Package Quantity
FLK	FLR			
–	1.2–1.6	Green	281934-4	50,000
–	1.7–2.4	Yellow	281934-2	50,000
–	2.5–3.3	Red	281934-3	50,000
Cavity Plug		Red	282081-1	50,000

Plug Housings

**Plug Housings**

Utilizes Receptacle Contacts

**Technical Features**

**Housing Material:**

Polyamide 6.6 glass-filled

**Color:**

Black (other colors available)

**Secondary Lock:**

Polyamide 6.6 glass-filled

**Color:**

Red

**Sealing:**

Silicon Rubber

**Color:**

Yellow

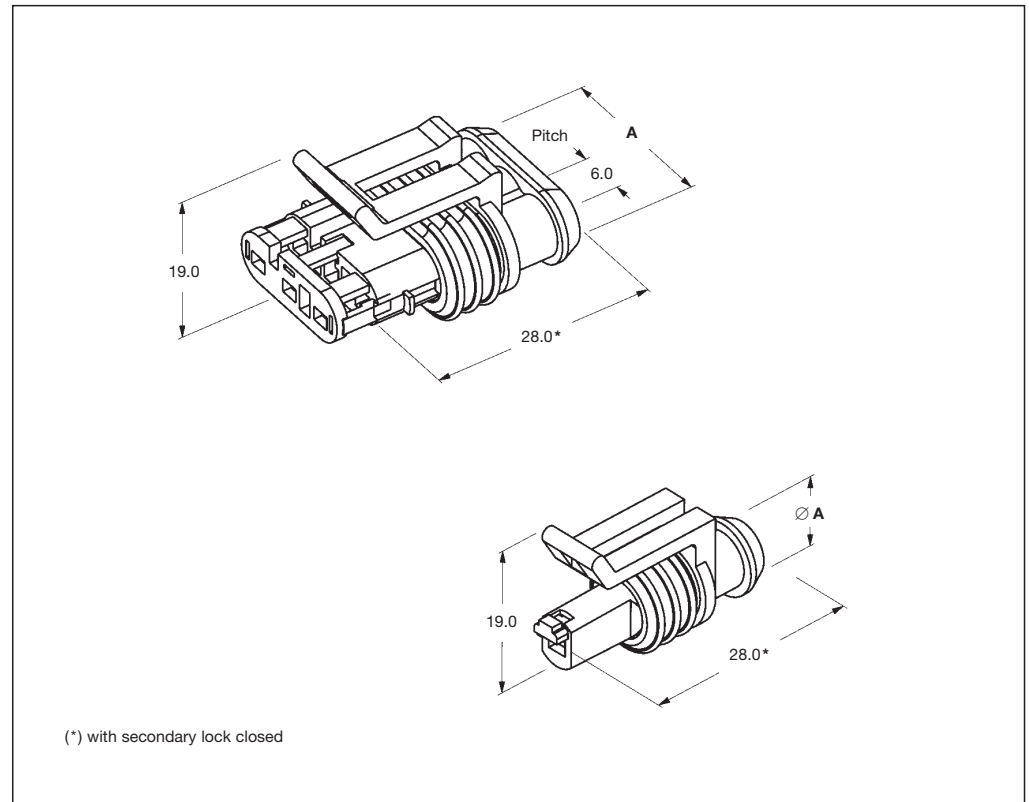

**Plug Housings**

No. of Positions	Dimension A	Part Number	Package Quantity
	(mm)		
1	9.3	282079-2	2,000
2	15.3	282080-1	1,000
3	21.3	282087-1	800
4	27.3	282088-1	600
5	33.3	282089-1	500
6	39.3	282090-1	400

Cap Housings

**Cap Housings**

Utilizes Tab Contacts

Also suitable for panel mount application (see detail "X")

**Technical Features**

**Housing Material:**  
Polyamide 6.6 glass-filled

**Color:**  
Black (other colors available)

**Secondary Lock:**  
Polyamide 6.6 glass-filled

**Color:**  
Red

**Extraction Tool for Secondary Lock of Cap Housing:**  
Part No. **785084-1**

**Insertion Tool for Secondary Lock of Cap Housing:**  
Part No. **785061-1**  
for 1 and 2 positions

Part No. **785061-2**  
for 3–6 positions

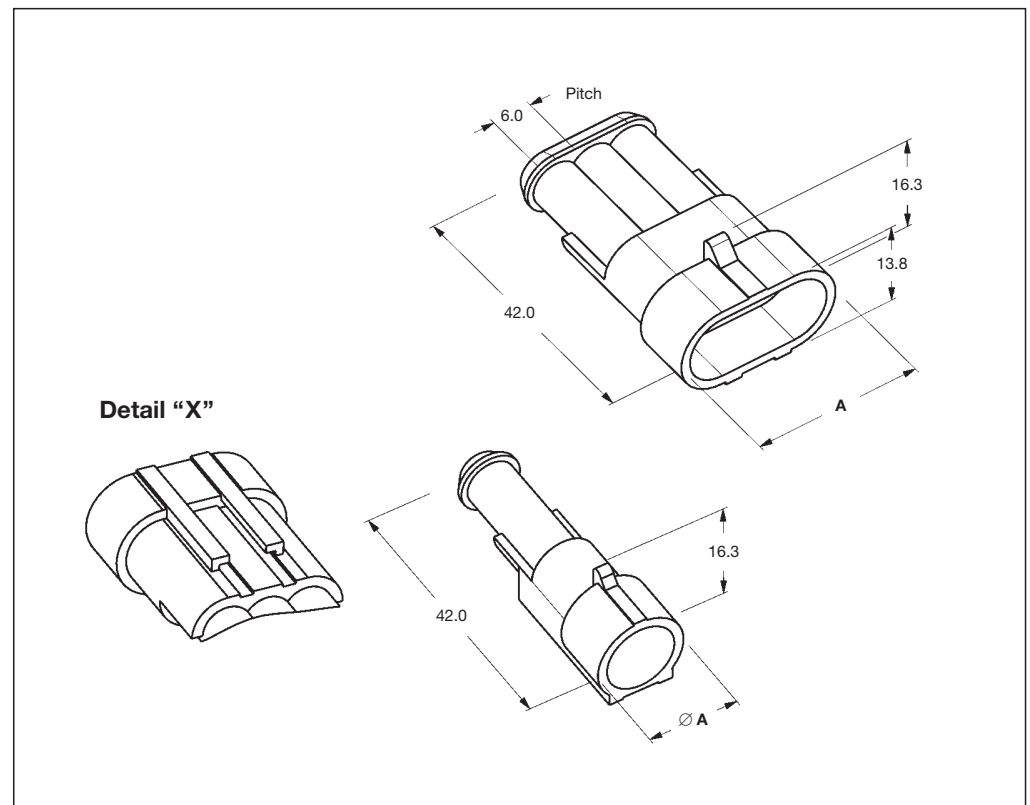

**Cap Housings**

No. of Positions	Dimension A	Part Number	Package Quantity
	(mm)		
1	13.8	282103-1	1,500
2	19.8	282104-1	1,000
3	25.8	282105-1	700
4	31.8	282106-1	500
5	37.8	282107-1	400
6	43.8	282108-1	350

Rubber Boots

Rubber Boots

Connector Housing Part Number	Description	No. of Positions	Rubber Boot Part Number	Color	Package Quantity
282080-1	Plug Housing	2	880810-1	Black	1,500
282104-1	Cap Housing				
282087-1	Plug Housing	3	880811-2	Black	1,000
282105-1	Cap Housing				
282089-1	Plug Housing	5	880814-1	Black	100
282107-1	Cap Housing				

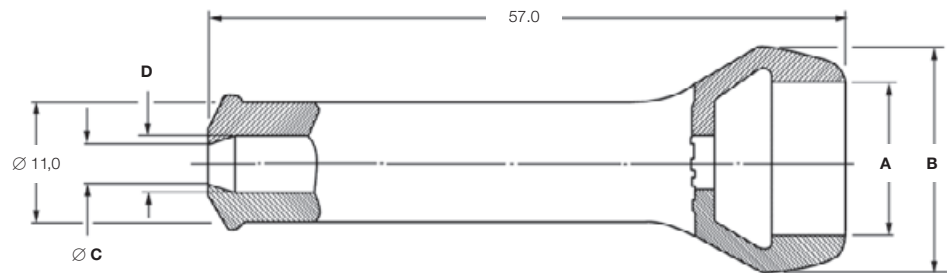

Dimensional Data

Boot Part Number	No. of Wires	Dimensions (mm)			
		A	B	C	D
880810-1	2	12.5	20.5	4.6	5.0
880811-2	3	17.5	25.5	4.6	5.0
493581-1*	4	21.0	34.5	–	7.0
880814-1	5	27.5	35.0	6.5	7.0

\* Different Style, see customer drawing

Engineering Notes



Introduction



~~Powertrain Systems~~



~~Chassis Systems~~



~~Safety Systems~~



~~Security~~



~~Body~~



~~Driver Information~~



~~Convenience~~



~~Car Industry~~



~~Truck Industry~~



~~Other Industry~~

Application Tooling from Tyco Electronics is designed to perform perfect terminations, time after time. Beyond that, the result is productivity gains, yielding more terminations for less money at the time of application, and in service. It is this combination of superior quality at a lower installed final costs that distinguishes the Tyco Electronics system solution.

Because production requirements vary, GATD – Global Application Tooling Division – can provide various levels of tooling to meet the full spectrum of output requirements.

The continuous support by our field service completes the Tyco Electronics system. Our field service engineers ensure the application equipment fulfill all requirements at any given time.

Find the latest Tooling and Equipment options for your application at: [www.tooling.tycoelectronics.com](http://www.tooling.tycoelectronics.com)

---

## Introduction

---

### Find Equipment:

---

- For Wire Processing
  - For PCB Processing
  - By Product Type
  - By Industry
- 
- How to Purchase
  - Documentation
  - Product Information Center
  - Service and Repair
  - Trade Shows
  - Country Contacts
  - European Tooling Home

Visit our Application Tooling Website at:  
**[www.tooling.tycoelectronics.com/europe](http://www.tooling.tycoelectronics.com/europe)**  
*Save it as one of your favourites.*

### Helping Yourself!

If you are new to referencing our Terminals / Contacts to tooling and equipment, we strongly recommend that you read our guide to selecting the right tool before continuing.

First, select the category you are looking for from the left-hand menu bar i.e:  
Hand Tool, Applicator, Lead Maker etc.

Generally there will be a brochure that will show top-level information on the range of equipment available for the category selected. Also, flyers that give more detailed information for each type of equipment listed in the brochure.

*On the Applicator and Hand Tool pages – you can search on Terminal Part Numbers for tooling options or by Tool Part Number for more equipment information.*

If you regularly need Hand Tool information, there is an online Hand Tool Catalogue that is available to view or print, but can also be printed and sent to you if more convenient.  
*This catalogue is updated regularly, so please ensure that your version is kept up to date.*

### Requesting Assistance

If you can't find what you are looking for, it does not necessarily mean that there is nothing available for your application:

For cross-referencing information – contact one of our Product Information Centers (PIC), listed when making a selection from the left-hand menu box.

For more complex equipment and technical help – find your country contact by selecting from the left-hand menu box.

*Local contact information is available for most countries in a one page pdf file.*

bt 752 – Stripper-Sealer-Crimper

**Technical Data**

**Crimp Force:**

20 kN (4500 lbf)

**Stripping Length:**

max. 12 mm (0.47 in)

**Wire Cross Section:**

0.08–4 mm<sup>2</sup> (AWG 28–AWG 12);  
Crimping up to 6 mm<sup>2</sup> (AWG 10)

**Bad Terminal Cut-Off and Zero Cut:**

0.08–2.5 mm<sup>2</sup>  
(AWG 28–AWG 13)

**Cycle Time:**

Approx. 1.9 sec

**Stroke Adjustment:**

10–40 mm (0.39–0.58 in)

**Seal Data:**

max. diameter 10 mm (0.39 in);  
max. length 8 mm (0.32 in)

**Electrical Connection:**

110–240 V 50/60 Hz

**Pneumatic Connection:**

5–8 bar (72.25–116 psi)

**Dimensions (W x H x D):**

500 x 850 x 920 mm  
(19.7 x 33.5 x 36.2 in)

**Weight:**

ca. 200 kg (441 lb)



The bt 752 delivers three processes in a single device: stripping, seal loading and crimping. Reliability and top production performance coupled with the user friendly TopTouch interface are the features that make this semi-automatic device such a compelling product. The bt 752 is an economical alternative to fully-automatic machines.

**Optimum Operation**

The operator controls the bt 752 from a color touch screen. With the TopTouch user interface, job setup is always quick and easy.

**Quality**

Only one crimp is needed for referencing the integrated crimp force analysis. This feature reduces the material used and minimizes the setup time.

With the programmable stripper, the device can be set up without mechanical adjustment. The zero-cut and way-back functions combine with a programmable cutting depth function to assure perfect stripping. Detectet bad crimps are automatically cut-off.

**Options**

- Contact strip chopper
- Air feed set

**Features**

- Ultra-short setup and cycle times
- Ultra-simple changeovers
- Active quality control beginning at the setup stage
- Minimal use of material for setup
- Simple operation with TopTouch
- Seal applications compatible with mci 761, mci 762 and bt 700
- Contact strip chopper
- Air feed cut

Find the latest Tooling and Equipment options for your application at: [www.tooling.tycoelectronics.com](http://www.tooling.tycoelectronics.com)

mci 761 – Seals Module

**Technical Data**

- Seals Diameter:**  
max. 10 mm (optional 17 mm)
- Seals Length:**  
max. 11 mm (optional 16 mm)
- Application Capacity:**  
approx. 4500 pcs/h
- Conversion Time:**  
<4 min.
- Electrical Connection:**  
110/220 V, 50/60 Hz
- Pneumatic Connection:**  
500–800 kPa (5–8 bar)

**Features**

- The supply drum can be replenished with seals faster
- All common types of seals can be processed in bulk (as loose seals)
- The feed rail and seals drum are compatible with the k 136
- Power is automatically switched over to match the voltages and frequencies in the country of operation
- Application set is compatible regardless of voltage and frequency



The mci 761 is a high performance seals module for applying seals to individual conductors. It offers a degree of operating convenience never before achieved by such modules. All inputs can be made with just two keys and a digital potentiometer. The straightforward OMI graphics display provides information in the selected language about the current processing status.

The seal module can be used with different leadmakers.

Tyco Electronics GATD website [www.tooling.tycoelectronics.com/europe/LeadMaker.stm](http://www.tooling.tycoelectronics.com/europe/LeadMaker.stm) provides an overview to available leadmakers.

Please contact your local representative to help with your requirements.

**Large Assortment of Seals**

The mci 761 can process all common types of seals up to 17 mm in diameter.

**Optional Seal Monitoring**

This option detects and signals material or application errors very early on, and the affected products are sorted out from the rest. Set-up requires only minimal effort because no adjustments are required mechanically or in relation to the parameters.

Moreover, already existing seal modules can be easily converted. Owing to its compact size, little space is required to integrate the seals monitoring unit. The graphic representation on the OMI is straightforward, and the device is easy to operate.

**Further Features of the Seal Monitoring**

- Intelligent communication with the machine
- Default settings for most lead/seals sets
- Integrated into mci 761 and TopWin
- Optimum access with swivelling sensor

**Accessories**

- Application set for all common types of single-conductor seals
- Application head for seals greater than 10 mm in diameter or 11 mm in length

Find the latest Tooling and Equipment options for your application at: [www.tooling.tycoelectronics.com](http://www.tooling.tycoelectronics.com)

mci 762 – Seals Module

**Technical Data**

- Seal Diameter:**  
ca. 2.5–10 mm
- Seal Length:**  
ca. 4–11 mm
- Conversion Time:**  
<5 min
- Processing Output:**  
up to 4500 pcs./h
- Seals Monitor:**  
integrated, optical
- Communication:**  
MCI (RS 458)
- Mains Voltage:**  
90–240 VAC, 50/60 Hz, 100 VA
- Air Connection:**  
5–8 bar
- Air Consumption:**  
3–5 m<sup>3</sup>/h
- Dimension (W x H x D):**  
225 x 600 x 530 mm
- Weight:**  
24 kg



The mci 762 seals module is a real standout in terms of user friendliness and compact design. Its excellent accessibility and integrated optical seals monitoring make this device an ideal module for the Alpha 455 and Zeta 633 automatic crimping machine.

The seal module can be used with different leadmakers.

Tyco Electronics GATD website [www.tooling.tycoelectronics.com/europe/LeadMaker.stm](http://www.tooling.tycoelectronics.com/europe/LeadMaker.stm) provides an overview to available lead-makers.

Please contact your local representative to help with your requirements.

**Function**

Thanks to its modular application sets and quick-release mecha-

nical locks, the seals module can be converted from one type of seal to another in no time at all. The application sets that are used are all fully compatible with the mci 761 seals module.

The most important functions of the seals module can be operated directly from a membrane keyboard. Thanks to its compact footprint and readily accessible interior, the device is simple to convert and ultra flexible.

It can be integrated into the Top-Win user interface, allowing it to be operated quickly and easily in 20 different languages. Parameters are automatically saved for each wire set and can be called up at any time.

Quality is assured by the optical seals monitoring unit integrated in the mci 762 as part of the standard equipment.

**Your Benefits**

- Compact footprint and easy accessibility
- Integrated seals monitoring
- Automatic separation of bad parts
- Short conversion times
- High processing output
- Application sets for all common types of seals
- Excellent process reliability
- Operator surface in 20 languages

**Applications**

- Sets for all common types of seals, including oval seals and seals with hard cores
- Compatible with mci 761 seals module
- Sets for special seals available at customer's request (f. i. O-Rings)

Find the latest Tooling and Equipment options for your application at: [www.tooling.tycoelectronics.com](http://www.tooling.tycoelectronics.com)

Numerical Index

Part Number	Page	Part Number	Page	Part Number	Page
58583-1	12, 13	282103-1	16	785061-1	16
183024-1	13	282104-1	16, 17	785061-2	16
183025-1	12	282105-1	16, 17	785084-1	16
183035-1	12	282106-1	16	880810-1	17
183036-1	13	282107-1	16, 17	880811-2	17
281934-2	14	282108-1	16	880814-1	17
281934-3	14	282109-1	13	1426361-1	12
281934-4	14	282109-3	13	1528018-1	12
282079-2	15	282110-1	12	1528199-1	13
282080-1	15, 17	282403-1	12	1528200-1	13
282081-1	14	282404-1	13	1528347-1	12
282087-1	15, 17	282404-3	13	1528463-1	13
282088-1	15	282465-1	13	9-1579007-1	12, 13
282089-1	15, 17	282466-1	12		
282090-1	15	493581-1	17		

**Americas**

**Argentina** – Buenos Aires  
Phone: +54-1-733-2000  
Fax: +54-1-717-0988

**Brasil** – São Paulo  
Phone: +55-11-2103-6000  
Fax: +55-11-2103-6200

**Canada** – Toronto  
Phone: +905-475-6222  
Fax: +905-474-5520

**Chile** – Santiago  
Phone: +56-2-739-1230  
Fax: +56-2-739-1227

**Colombia** – Bogota  
Phone: +57-1-231-9398  
Fax: +57-1-240-3769

**Mexico** – Mexico City  
Phone: +52-5-729-0400  
Fax: +52-5-361-8545

**United States**  
Harrisburg, PA  
Phone: +1-717-564-0100  
Fax: +1-717-986-7575

Troy, MI  
Phone: +1-248-273-3359  
Fax: +1-248-273-3322

**Customer Service:**  
Phone: +1-800-522-6752

**Venezuela** – Caracas  
Phone: +58-2-986-7774  
Fax: +58-2-986-9739

**For Latin/South American Countries not shown**  
Phone: +54-11-4733-2015  
Fax: +54-11-4733-2083

**Asia/Pacific**

**Australia** – Sydney  
Phone: +61-2-9554-2600  
Fax: +61-2-9502-2556

**India** – Bangalore  
Phone: +91-80-2854-0800  
Fax: +91-80-2854-0820

**Indonesia** – Jakarta  
Phone: +62-21-526-7852  
Fax: +62-21-526-7856

**Japan** – Kawasaki, Kanagawa  
Phone: +81-44-844-8111  
Fax: +81-44-812-3207

**Korea** – Seoul  
Phone: +82-2-3415-4500  
Fax: +82-2-3486-3810

**Malaysia** – Selangor  
Phone: +60-3-7805-3055  
Fax: +60-3-7805-3066

**New Zealand** – Auckland  
Phone: +64-9-634-4580  
Fax: +64-9-634-4586

**Philippines** – Makati City  
Phone: +632-867-8641  
Fax: +632-867-8661

**People's Republic of China**  
Hong Kong  
Phone: +852-2735-1628  
Fax: +852-2735-0243

Shanghai  
Phone: +86-21-6485-7333  
Fax: +86-21-6485-6222

**Singapore** – Singapore  
Phone: +65-480-4525  
Fax: +65-482-1012

**Taiwan** – Taipei  
Phone: +886-2-2664-9977  
Fax: +886-2-2664-9900

**Thailand** – Bangkok  
Phone: +66-2-955-0500  
Fax: +66-2-955-0505

**Vietnam** – Ho Chi Minh City  
Phone: +84-8-930-4547  
Fax: +84-8-930-3443

**Europe/Middle East/Africa**

**Austria** – Vienna  
Phone: +43-1-905-60-0  
Fax: +43-1-905-60-1333  
**Product Information Center:**  
Phone: +43-1-905-60-1249  
Fax: +43-1-905-60-1251

**Belgium** – Kessel-Lo  
Phone: +32-16-352-300  
Fax: +32-16-352-352

**Bulgaria** – Sofia  
Phone: +359-2-971-2152  
Fax: +359-2-971-2153

**Czech Republic** – Kurim  
Phone: +420-5-41-162-111  
Fax: +420-5-41-162-223  
**Product Information Center:**  
Phone: +420-5-41-162-113  
Fax: +420-5-41-162-132

**Denmark** – Glostrup  
Phone: +45-43-480-452  
Fax: +45-43-441-414

**Egypt** – Cairo  
Phone: +20-2-417-76-47  
Fax: +20-2-419-23-34

**Finland** – Helsinki  
Phone: +358-95-12-34-20  
Fax: +358-95-12-34-250

**France** – Cergy-Pontoise Cedex  
Phone: +33-1-3420-8888  
Fax: +33-1-3420-8600  
**Product Information Center:**  
Phone: +33-1-3420-8686  
Fax: +33-1-3420-8623

**France Export Divisions** –  
Cergy-Pontoise Cedex  
Phone: +33-1-3420-8866  
Fax: +33-1-3420-8300

**Germany** – Bensheim  
**Tyco Electronics AMP GmbH**  
Phone: +49-6251-133-0  
Fax: +49-6251-133-1600  
**Product Information Center:**  
Phone: +49-6251-133-1999  
Fax: +49-6251-133-1988

**Germany** – Niefern  
**Tyco Electronics pretema GmbH & Co. KG**  
Phone: +49-7233-69-0  
Fax: +49-7233-69-100

**Germany** – Ottobrunn  
**Tyco Electronics Raychem GmbH**  
Phone: +49-89-6089-0  
Fax: +49-89-6096-345

**Great Britain** –  
Stanmore Middlesex  
Phone: +44-8706-080-208  
Fax: +44-1793-572-109  
**Product Information Center:**  
Freephone GB: 0800-267-666  
Phone: +44-208-420-8341  
+44-208-420-8343  
Fax: +44-208-420-8081

**Greece** – Athens  
Phone: +30-210-9370-396/397  
Fax: +30-210-9370-655

**Hungary** – Budapest  
Phone: +36-1-289-1000  
Fax: +36-1-289-1010  
**Product Information Center:**  
Phone: +36-1-289-1016  
Fax: +36-1-289-1017

**Ireland** – Dublin  
Phone: +353-1-820-3000  
Fax: +353-1-820-9790

**Israel** – Yokneam  
Phone: +972-4-959-0508  
Fax: +972-4-959-0506

**Italy** – Collegno (Torino)  
Phone: +39-011-4012-111  
Fax: +39-011-4031116  
**Product Information Center:**  
Phone: +39-011-4012-360  
Fax: +39-011-40287360

**Lithuania** – Vilnius  
Phone: +370-5-2131-402  
Fax: +370-5-2131-403

**Netherlands** – 's-Hertogenbosch  
Phone: +31-73-6246-246  
Fax: +31-73-6212-365  
**Product Information Center:**  
Phone: +31-73-6246-999  
Fax: +31-73-6246-998

**Norway** – Nesbru  
Phone: +47-66-77-88-86  
Fax: +47-66-77-88-55

**Poland** – Warsaw  
Phone: +48-22-4576-700  
Fax: +48-22-4576-720  
**Product Information Center:**  
Phone: +48-22-4576-704  
Fax: +48-22-4576-720

**Romania** – Bucharest  
Phone: +40-21-311-3479 + 3596  
Fax: +40-21-312-0574

**Russia** – Moscow  
Phone: +7-495-926-55-06...09  
Fax: +7-495-926-55-05

**Russia** – St. Petersburg  
Phone: +7-812-718-8192  
Fax: +7-812-718-8193

**Slovenia** – Ljubljana  
Phone: +386-1561-3270  
Fax: +386-1561-3240

**South Africa** – Port Elizabeth  
Phone: +2741-503-4500  
Fax: +2741-581-0440

**Spain** – Barcelona  
Phone: +34-93-291-0330  
Fax: +34-93-201-7879

**Sweden** – Upplands Väsby  
Phone: +46-8-50-72-50-00  
Fax: +46-8-50-72-50-01

**Switzerland** – Steinach  
Phone: +41-71-447-0447  
Fax: +41-71-447-0444

**Turkey** – Istanbul  
Phone: +90-212-281-8181...3  
+90-212-282-5130/5430  
Fax: +90-212-281-8184

**Ukraine** – Kiev  
Phone: +380-44-206-2265  
Fax: +380-44-206-2264



***tyco***

*Electronics*

Tyco Electronics AMP GmbH  
AMPästr. 12-14 • 64625 Bensheim  
Phone: +49-(0)6251-133-0  
Fax: +49-(0)6251-133-1600  
[www.tycoelectronics.com](http://www.tycoelectronics.com)

AMP, AMP SUPERSEAL and TYCO are trademarks.

*a vital part of your world*

© 2006 Tyco International  
1654292-1 Issued 04-2006 3M ST(Z)